

# Hydropanel instructions

Tongue & Groove or square cut wall panels

## General notes on fixing panels

Panels can be fixed direct to battens or walls using Hydropanel panel adhesive. It is recommended that the panels are fixed to battens to provide air space behind. Fix treated timber battens approximately 45mm x 21mm horizontally with one at the head and one at the base of the panels. Additional horizontal battens should be a maximum distance of 500mm apart. They should be parallel to each other and plumb to give a solid ground for fixing the panels with Hydropanel adhesive. Additional battens should be used behind wash hand basins, towel rails and other heavy items to give a secure fixing.

## Panel Preparation

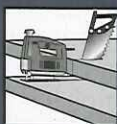

### Cutting Panels:

Cut panel with pattern facing upwards using a handsaw. If using an electric saw, cut panel with laminate face downwards.

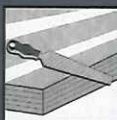

### Cut Edge Filing:

The panel edge should be filed at a slight angle away from the laminate edge.

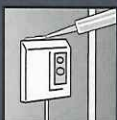

### Pipes and Accessories:

All pipes and accessories require a 3-4mm clearance, allowing them to be sealed with a bead of Hydropanel sealant. If fitting a collar, first seal with Hydropanel sealant.



### TIMBER BATTENS: (45mm x 21mm)

Use battens if walls are uneven, at a maximum distance of 500mm apart. Fix panels to battens using Hydropanel adhesive.



**PANEL FITTING:** Fit panels 3mm above bath, shower tray or floor, with edge downwards. Seal gap with Hydropanel sealant. It is imperative that all edges are

sealed and the sealant is taken 5mm up the face of the panel at a 45° angle.

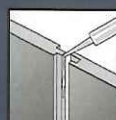

### PANEL & DECOR STRIP SEALING:

In wet areas such as a bathroom, use Hydropanel sealant inside each profile prior to inserting panel.



## HYDROPANEL Tongue & Groove Recommended for continuous panel runs

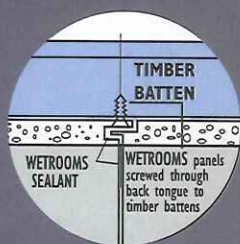

The vertical edges are tongue and grooved to give the finished panelling a smooth, easily maintained surface. Panels have asymmetrical tongue and grooved vertical edges giving 5mm of joint overlap. A waterproof joint is assured when sealed with Hydropanel sealant.

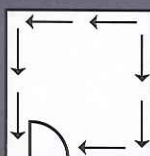

### INSTALLATION

#### Where to start:

Panel in both directions around the room, starting at the corner furthest from the door. Fit the last panel above the doorway, placed in position tongue first and swung into position. All panels must be correctly aligned and plumb. Use Hydropanel panel adhesive to fix panels to battens. Seal all panel joints using Hydropanel sealant.



#### Begin Panelling:

Fix a Hydropanel internal profile in position first ensuring that it is plumb. Apply Hydropanel sealant to the recess of the profile.

Apply Hydropanel adhesive to the battens. After removing the smaller tongue, or cutting to size insert the first panel. Continue to panel away from the corner in both directions, fixing panels to battens with Hydropanel adhesive, and sealing joints with Hydropanel sealant.



#### Continue Panelling:

Continue panelling around the room fixing each panel to the battens with Hydropanel adhesive, or screws through the back lip of grooved edge. Seal tongue and groove joints with Hydropanel sealant. Where appropriate use internal and external corner profiles, sealing with Hydropanel sealant.

using Hydropanel sealant.

## HYDROPANEL Square edged Recommended for shower panels

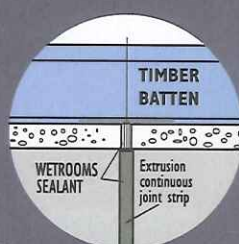

Square cut with aluminium joint extrusions which allow for on site cutting, the edges being covered by aluminium trim extrusions. This will facilitate for faster installation.

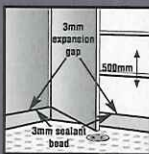

### INSTALLATION

#### Two panel shower enclosure:

Fit the shower tray hard against or cut into the wall. First cut the panels and profiles to size. Fix a Hydropanel internal profile

in position ensure that it is plumb. Apply Hydropanel sealant into profile and insert panels. Fix panels to battens using Hydropanel panel adhesive.

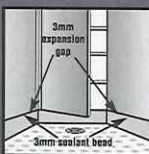

#### Three panel shower enclosure:

First panel is fitted as for the two panel shower enclosure. Put a second internal corner profile onto the edge of second panel, and apply

Hydropanel adhesive to the battens. Insert other edge into profile already attached to the wall, and swing into place forming back of enclosure. Fix profile to wall, insert third panel and glue to wall. Ensure a generous bead of Hydropanel sealant is applied into all the profiles.



#### Finishing touches U-Trim:

Finish outer panel edges with U-Trim, applying a bead of Hydropanel sealant into the U-Trim. Seal all gaps around the tray with Hydropanel sealant prior to installing the shower door or side panel.

#### Square edge panelling for continuous wall installations

Use the H continuous run decorative aluminium joining and stacking profile to join panels and install in a similar manner to tongue and groove panelling, applying a generous bead of Hydropanel sealant into the profile.

## Aluminium Profiles

Available in silver, white and antique gold

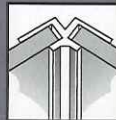

### Internal corner profile:

2400mm. Used on all internal 90° corners sealing with Hydropanel sealant.



### External corner profile:

(2500 mm) Used on 90° external corners, sealing with Hydropanel sealant.



### Joining and stacking profile:

(2500 mm) Used to mount panels side by side, or above each other, sealing with Hydropanel sealant.

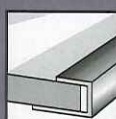

### U-TRIM:

(2500 mm) Finishing touches and cap for square cut edge of panel, sealing with Hydropanel sealant.

## Hydropanel Adhesives and Sealants

It is recommended that only Hydropanel's own brand adhesives and sealants are used. Approximately 1 cartridge of Hydropanel adhesive and 1 cartridge of Hydropanel sealant is required for a 800 mm wide panel.

## Cleaning and maintenance

The hardwearing surface of the panelling and aluminium profiles can be hygienically cleaned with Hydropanel spray cleaner which is a mild non-abrasive cleaner with anti-bacterial cleanser.

*Abrasive cleaners or bleach must not be used.*

## A large variety of possible applications:

**DOMESTIC:** Walls of showers, kitchens, wet areas, utility rooms, conservatories, extensions etc.

**COMMERCIAL:** Hotels (bathrooms, kitchens, wet areas, reception areas, etc). Cafeterias (food preparation areas, kitchens, toilet facilities, etc) offices, shops, hospitals, schools, laboratories, etc.



# How to fit the PVC Profiles

- Hygienic, washable and easy to maintain
- Very simple to install
- Can be cut to size very easily

- Save up to 50% of the cost of conventional tiling.
- Ideal for bathrooms, showers, kitchens etc.

- A wide range of stunning decors
- Excellent insulation and sound proofing
- Recyclable



END CAP U

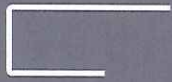

H JOINT AND DECOR STRIP

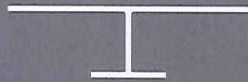

INTERNAL



EXTERNAL CORNER

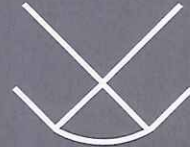

## Assembly Instructions

### FIX DIRECTLY ONTO WALL



There are two ways to assemble the tongue and groove wall panels. Either glue or fix directly on to the wall if the surface is relatively even and dry. Use 'Wetwall Adhesive' or fix on to a wooden frame. Fixing to timber battens is easy: a staple gun, hammer and nails, screws or 'Wetwall Adhesive' can be used.

To make the wooden frame, strap the wall with wooden battens approx. every 50cm according to the direction of your panel assembly. To install the panels vertically, lath the wall horizontally and vice versa. If the panels are to

be placed diagonally, the wall may be lathed either horizontally or vertically.

Start with installing the preferred P.V.C. profiles on the sides (start and edge trim, or inside corner).

Nail, staple, screw or glue the first panel to the wooden battens. Silicone seal all ends, joints and profiles in a wet area such as a shower or around a bath with Wetwall sealant.

Insert the next panel (side with tongue) into the groove of the previous panel. Nail, staple, screw

or glue the panel along the tongue on the opposite side. Proceed in a similar manner for the fixing of all panels.

**SEALING:** To seal the joint between two panels we recommend using 'Wetwall Silicone Sealant' when sealing in wet areas, in the shower or around the bath.

**CUTTING:** We recommend when using a precision handsaw, cutting the panel with the decorative side upwards. When using an electric saw cut panel with decorative side downwards.

### BENEFITS OF USING WETROOM ADHESIVES, SEALANTS AND CLEANERS

Wetroom Sealant is of the highest quality silicone. It is a fast curing, low modulus, neutral, fungicidal silicone sealant, developed for use with Wetroom panelling, and for general sanitary use.

- Wetroom Sealant forms a strong secure bond even between two non-porous surfaces.
- Wetroom Sealant has a high degree of elasticity, which ensures that the bond remains firm during the natural expansion and contraction of the panelling.
- Wetroom Sealant is designed for high pressure and pumped shower systems.

**It is strongly recommended that only Wetroom's own brand of adhesive sealant and cleaner are used.**

For a packet of 4 panels, approximately 1 cartridge of Wetroom adhesive and 1 cartridge of Wetroom sealant is required. The surface of the panelling can be hygienically cleaned with Wetroom Spray Cleaner which is a mild non-abrasive cleaner with an anti-bacterial agent.

**Abrasive cleaners and bleaches must NOT be used on Wetroom panelling.**



### Accessories

Description	Code	£ Ex VAT	£ Inc VAT
Hydropanel Adhesive 310ml *	32.005	9.00	10.80
Hydropanel Sealant 310ml *	32.006	9.00	10.80
Hydropanel Cleaner 500ml	32.007	7.00	8.40

\*Normal requirement one tube per panel

### FIX DIRECTLY ONTO BATTEN

